

## Freedom Accessible Shower 60" x 31"

Model  
APF6030BFC5P75

60" x 31" x 78"

5-piece for remodeling

3/4" barrier free threshold  
with pre-leveled and  
reinforced shower base  
for easy installation

Molded soap ledge

Durable, luxurious and  
easy to clean gelcoat  
fiberglass with 8" tile pattern

Full wood backing in  
walls offers strength and  
easy installation of  
accessories

Accessories available:  
Grab bars, folding shower  
seat, collapsible water  
retainer, weighted shower  
curtain and rod, slide bar  
with handheld shower,  
pressure balance valve,  
caulkless drain



- Shower shown with available accessories
- Shower stall comes standard in white
- Other wall configurations available
- Made in America
- 30 Year Limited Warranty

# FREEDOM SHOWERS

## MODEL: APF6030BFC5P75 Freedom Accessible Shower

### Submittal Data

#### Product Features

- 60" x 31" x 78"
- 5-piece for remodeling
- 3/4" barrier free threshold
- Self-supporting and pre-leveled shower base eliminates mud setting
- Full fiberglass encapsulated wood backing on walls
- tile pattern easy to clean gelcoat finish
- 3.5" bottom soap ledge depth
- Textured slip-resistant floor
- Center drain location

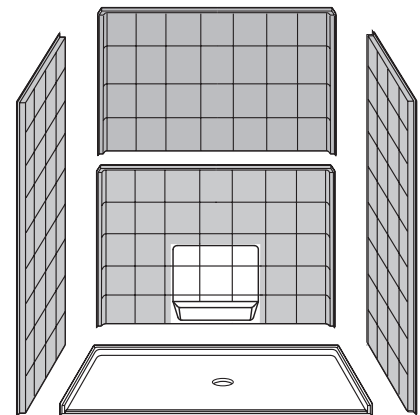

#### Code Compliance

- IPC International Plumbing Code
- UPC Uniform Plumbing Code
- ANSI Z124.2 Standards for Plastic Showers
- CSA

#### Optional Accessories (Installed at job site)

- Collapsible Water Retainer
- Folding Shower Seat
- Caulkless Drain
- Grab Bars
- Shower Rod and Curtain
- Pressure Balance Valve with hand-held Shower and Slide Bar

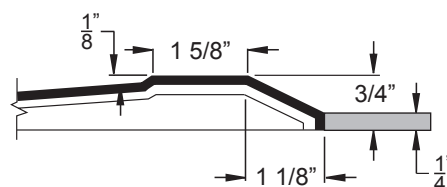
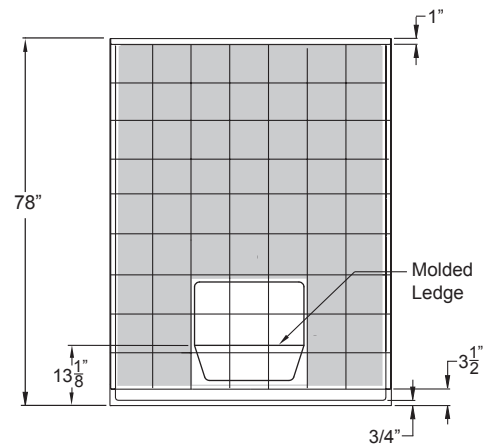

THRESHOLD VIEW

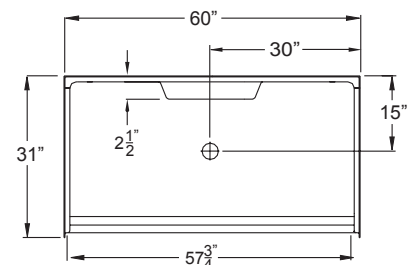

# FREEDOM SHOWERS

## MODEL: APF6030BFC5P75 Freedom Accessible Shower Submittal Data - Installation

BASE / WALL MATING DETAIL

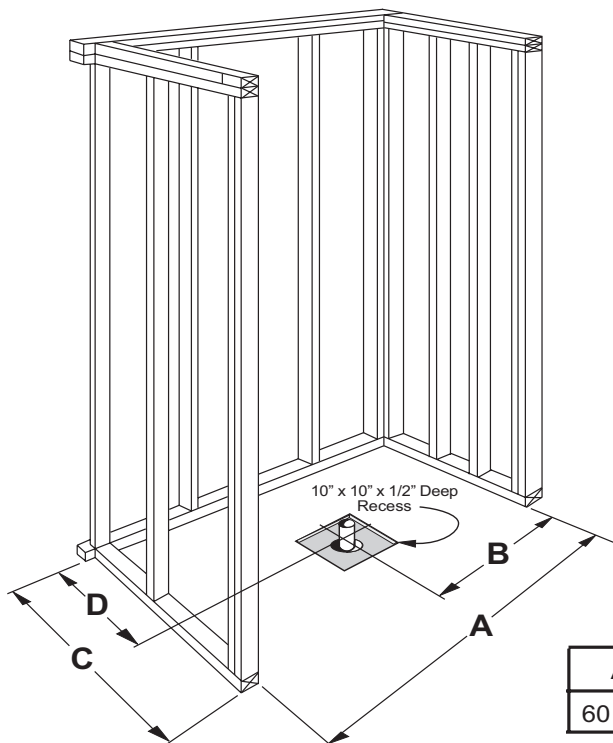
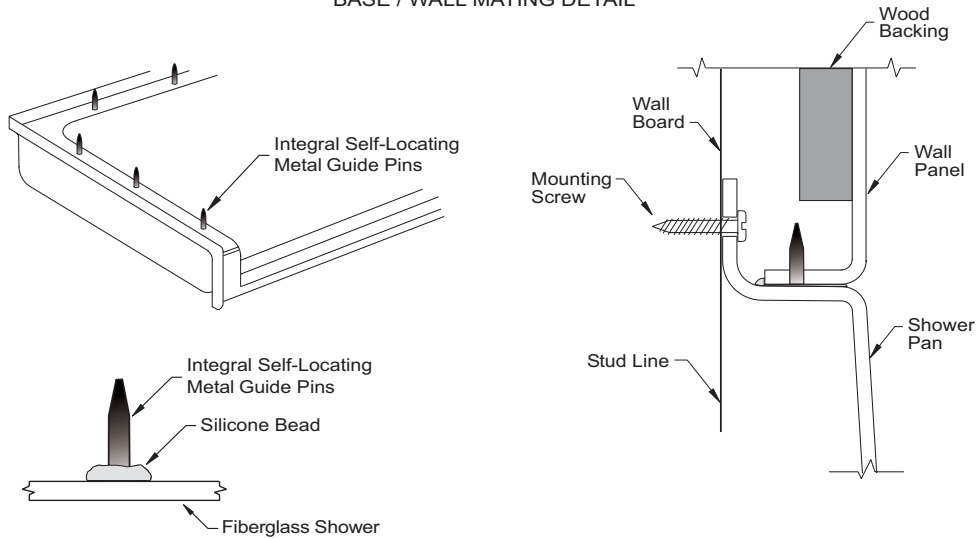

A	B	C	D
60 1/4"	30 1/8"	31 1/4"	15"